

RHB正面更換背光按鈕

RHB Direct Replaceable Pushbuttons

通過 IP67 (CE 認證!!)
IP67 Approved
CE Certified

特性

- IP67認證通過，全面防水、防塵及防油。
- 直接從面板正向取換LED按鍵模組，免拆卸整片電路板，縮短原廠維修時間與成本。
- 適用於各種型式版面，面板內側可避免多餘的植釘處理，並省下面膜覆貼成本。
- 按鍵可單獨使用，或以零間隙之排列使用，不受制式排列限制，面版型式更趨人性化。
- 提供單色與雙色LED背光按鈕，顯示清晰，操作方便。
- 提供各種標準操作圖形，方便設計選用。
- 按鍵材質透光優異，美觀耐用。

FEATURES

- IP67 certificated, resist against to water, dust and grease.
- Innovative design enables the replacement of the push button direct on the control panel.
- Versatile panel design, nailing of the inner side panel can be avoided and cost saving of the surface membrane.
- Buttons may be installed as single or array appearance, without restrained in restrict styles.
- Single or two-color LED backlighting provide much more options for operational designators.
- Various icons of operational designators are offered.
- Excellent transparent button provides elegance and durability.



XPB LED模塊

台灣專利 大陸專利

- 可任意排列
- 不受模組限制
- Allows for arranged as desired.
- Not restricted by module.

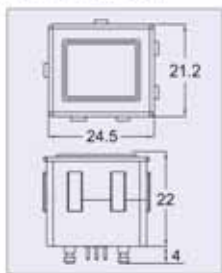

RHB1.RHB2尺寸圖

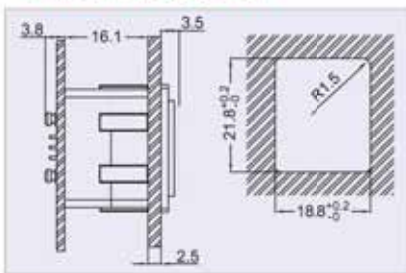

RHB1.RHB2鍍金開孔圖

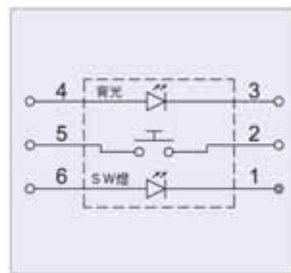

XPB電路圖

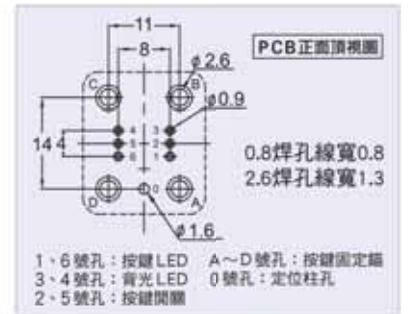

RHB1.RHB2腳位定義圖

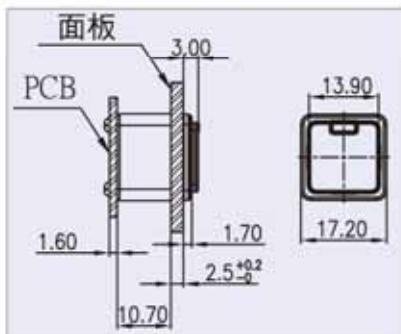

RHB3.RHB4尺寸圖

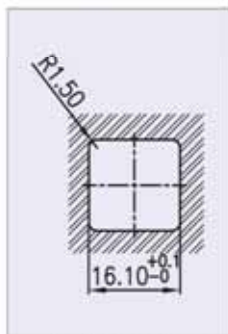

鍍金開孔尺寸

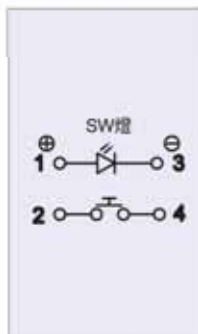

電路圖

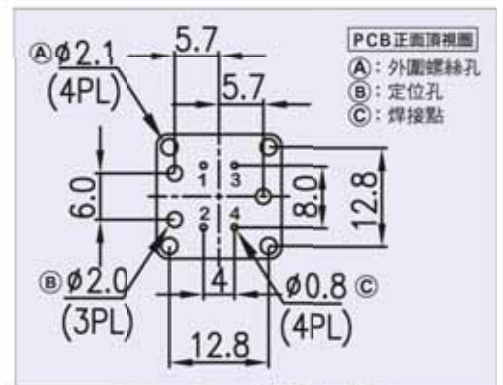

RHB3.RHB4腳位定義圖

訂購編號 ORDERING INFORMATION

RHBx

-

WB

-

W

系列名稱： Series：
RHB1 (單色光-大) Single LED Large
RHB2 (雙色光-大) Tow Color Table Large
RHB3 (單色光-小) Single LED Small
RHB4 (無LED) NON-LED

LED顏色： LED Color：
單色 (XPB1)：YL (黃色) Single Color：YL (Yellow)
BL (藍色) BL (blue)
GN (綠色) GN (green)
WH (白色) WH (white)
雙色 (XPB2)：WB (白/藍色) Double Color：WB (white / blue)
WY (白/黃色) WY (white / Yellow)

標示牌顏色 (Icon Color)：
白W (W-White)
淺灰LG (LG-Light Grey)
深灰DG (DG-Dark Grey)
黃Y (Y-Yellow)
天空藍SB (SB-Sky Blue)
肌色S (Skin color)
綠G (G-Green)
紅R (R-Red)